

WALL MOUNTED DEFLECTION BEAD

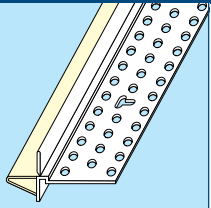

72-9220 Wall Mounted Deflection Bead (3000mm)

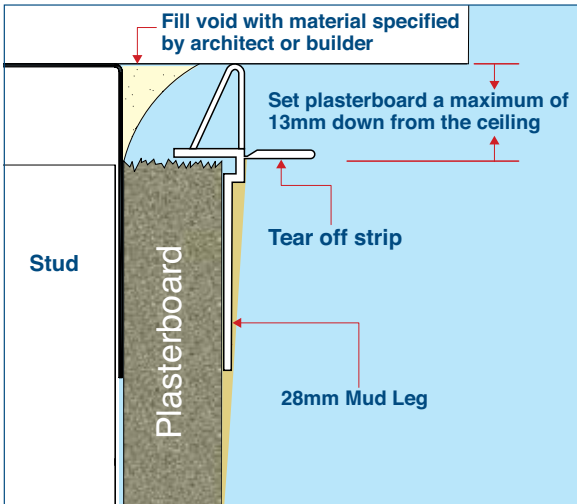

Spray Adhesive 847

Spray a liberal coat of 847 to the inside of the bead as well as the surface of the plasterboard. Apply firm even pressure to ensure a solid bond.

Trim-Tex 847 Spray Adhesive is a high tack, pressure sensitive spray adhesive specifically designed to be used to install Trim-Tex Beads.

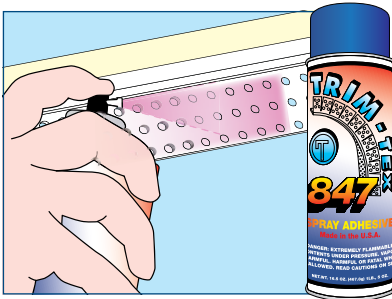

PAINTING

- Trim-Tex Deflection Bead is designed for structural movement (expansion and contraction)
- Always use good quality paint that will bond to the flexible gasket (refer to paint manufacturers specifications)
- Do not prime the flexible gasket - if applying a primer with a spray gun remove any primer from the gasket
- Cut in final coat of paint by brush
- The heavier the build up of paint on the gasket the less chance of achieving the required finish result

NOTES:

- This bead is for interior use only
- The incorrect installation of Trim-Tex Beads will void any Warranty (see Trim-Tex Product Warranty at www.wallboardtools.com.au)
- Textures are not designed to be pliable - they will crack if applied to the flexible gasket of the Deflection bead. Do not apply texture to the flexible portion of this bead

INSTALLATION

- Hang your wall plasterboard no more than 13mm from the ceiling
- Fill the void shown in the installation diagram with materials specified by the architect or builder
- Cut your bead to length and dry fit creating a seal between the flexible gasket and the ceiling
- Spray a liberal coat of Trim-Tex Adhesive Spray (72-847) to the inside of the mud leg as well as to the plasterboard surface where the Trim is to be installed
- Apply firm, even pressure to the mud leg using a Trim-Tex Cleaning Tool to ensure the best possible bond
- Staple through the mud leg at 200mm centres maximum using 10mm staples
- Reapply pressure to the mud leg of the bead if required
- Refer to mitring instructions when installing Wall Mounted Deflection bead into corners
- Set the Trim-Tex bead with approved compound (refer to standard ASTM-C475-02 (2007) or the plasterboard manufacturers recommendations)

INSTALLATION ON UNEVEN CEILINGS

- If installing Wall Mounted Deflection Bead against a slightly uneven ceiling (up to 3mm). Press the Deflection Bead up so there is no gap at the ceiling. Continue installation as normal by applying Spray Adhesive to the mud leg of the bead and the surface of the plasterboard where the bead is to be installed (UC-1)
- For ceilings that have a step down measuring more than 3mm, cut the deflection bead into 2 pieces and install them separately. Cut each piece to size and install both against the ceiling so there is no gap. Continue installation as normal by applying Spray Adhesive to the mud leg of the bead and the surface of the plasterboard where the bead is to be installed (UC-2)



MITRING INSTRUCTIONS

90° Inside Corner

- Snip a "v" notch into the Tear Away strip (MI-1)
- Flip the bead over and snip the mud leg all the way through the mud bump and into the back of the flexible gasket - ensure the front of the gasket is not cut (MI-2)
- Bend the bead so it forms a nice, clean inside corner (MI-3)

90° Outside Corner

- Snip the mud leg all the way through the mud bump and Tear Away strip - do not cut the gasket (MI-4)
- Flip the bead over and snip a "v" notch slightly going into the gasket (MI-5)
- Bend the bead so it forms a nice, clean outside corner (MI-6)



For further details please contact Wallboard Tools
Phone: 1300 653 177 | Fax: 1300 657 442 | Email: sales@wallboardtools.com.au
www.wallboardtools.com.au | www.plasterart.com.au

 TEARAWAY  UV STABILISED



www.facebook.com/plasterart

PRODUCT DATA SHEET